

# X-SMART (EL1250H)

LED LIGHT TOWER

## Diesel Powered

**Carbon Footprint - 82% LESS**  
**Annual Fuel Cost - 61% LESS**  
**Total Operating Cost - 63% LESS**  
**Compared to a Metal Halide**



- Full run time 288 hrs - that's almost a full month of darkness on one tank of diesel! Refuel once a month versus five times a month with metal halide towers. Save on fuel and labor refueling costs!
- 4 x 320W high efficiency LED light heads have a 5 year warranty and are easily tilted & rotated by hand covering a 52,900 sq ft area.
- Kubota Z482-E4B engine with 1,000 hour service intervals
- Hydraulically operated vertical mast fully raises in 10 sec. with the push of a button with 26' maximum height.
- Set the timer and go! No need to send labor to start every night. Use programmable event timer or dusk to dawn switch. Save time and money!
- Built for a long life! Rugged 14 gauge steel enclosure and fenders are galvanized and powder coated inside and out. Documented towers with 30,000+ hours.
- 110% containment base

## Trime X-SMART Specifications

Mast, Dimensions & Weight		
Mast Height	26'	
Wind Rating	50 mph	
Fully Retractable Stabilizers	Y	
Axle	Torsion	
Drawbar	Tubular Steel	
Unit Dimensions - Stowed	95"l x 57"w x 98"h	
Operating Dimensions	95"l x 107"w x 315"h	
Dry Weight	1964 lbs	
Operating Weight	2270 lbs	
Engine		
Make	Kubota	Kohler
Model	Z482-E4B	KDW702
Emission Regulation	Tier 4	
Type	Vertical 4 Cycle Liquid Cooling Diesel	
Cylinder	2	
Displacement / L (cu. In.)	0.479 (29.23)	
Combustion System	IDI	
Intake System	Naturally Aspirated	
Maximum Speed	1800 rpm	
Sound Level @ 23'	65 dBA	
Alternator		
Make	Linz	
Output	4.2 kVA	
Hz	60	
Fuel		
Type	Diesel	
Fuel Capacity	46 gal.	
Run Time	288 Hrs	
Secondary Containment		
Containment Base	110%	

\*Specs subject to change. Ask about engine.

## Applications

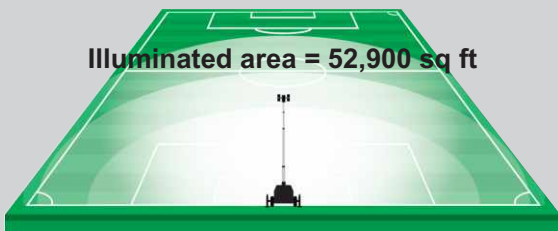

## OPTIONS

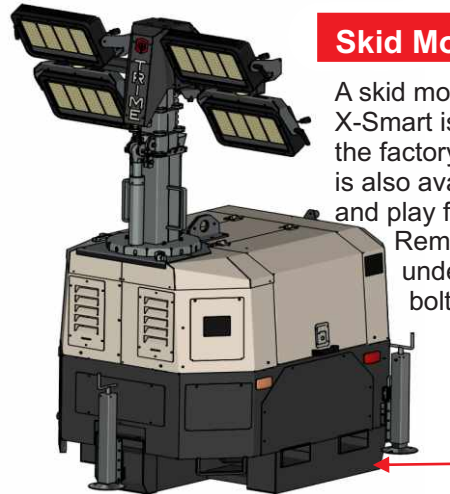

### Skid Mount

A skid mount version of the X-Smart is available from the factory. The skid itself is also available as a plug and play for existing towers. Remove existing undercarriage and bolt on skid.

### Anti-Glare Light Heads

Anti-glare light heads are available as an option in place of the standard 320W light head. There is a 10% less square footage difference with the anti-glare heads, but more economical than other options out there.



### Receiver Hitch

The receiver hitch gives user the ability to tow two towers together safely, one hooked to the back of the other. It bolts into the existing frame and axle. FOR CONSTRUCTION SITE USE ONLY.

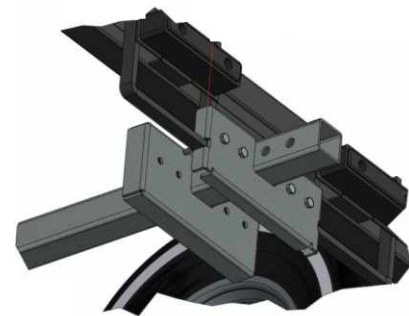

Trime US, Inc.  
3 Killdeer Court, Suite 301  
Swedesboro, NJ 08085  
www.trimeusa.com

(877) 97TRIME  
(877) 978-7463  
sales@trimeusa.com